



**EXPANSVE BEACHFRONT
PROPERTY
IN KIZIMKAZI**

PRICE
\$ 2,500,000.00

PROPERTY OVERVIEW

Situated on the southern coast of the island in Kizimkazi, this beachfront real estate offers an impressive 200 meters of pristine white sand beach. Its expansive size and prime location make it ideal for both residential and commercial development, presenting a compelling opportunity for investors.

The property is easily accessible by road and is well-connected to electricity and government water supplies, making it ready for immediate development. Spanning a vast 69,500 square meters of untouched land, it offers ample space for construction, further enhancing its appeal.

Owned by an Egyptian national with all necessary title and ownership documentation, this exceptional property ensures a seamless and secure transaction. Seize the opportunity to invest in this rare gem within the realm of premium real estate.

LAND FEATURES

 69,500 sqm

 200 meters beachfront

 White Sand Beach

 Electricity

 Easy Road Access

 USD 35.9 per sqm

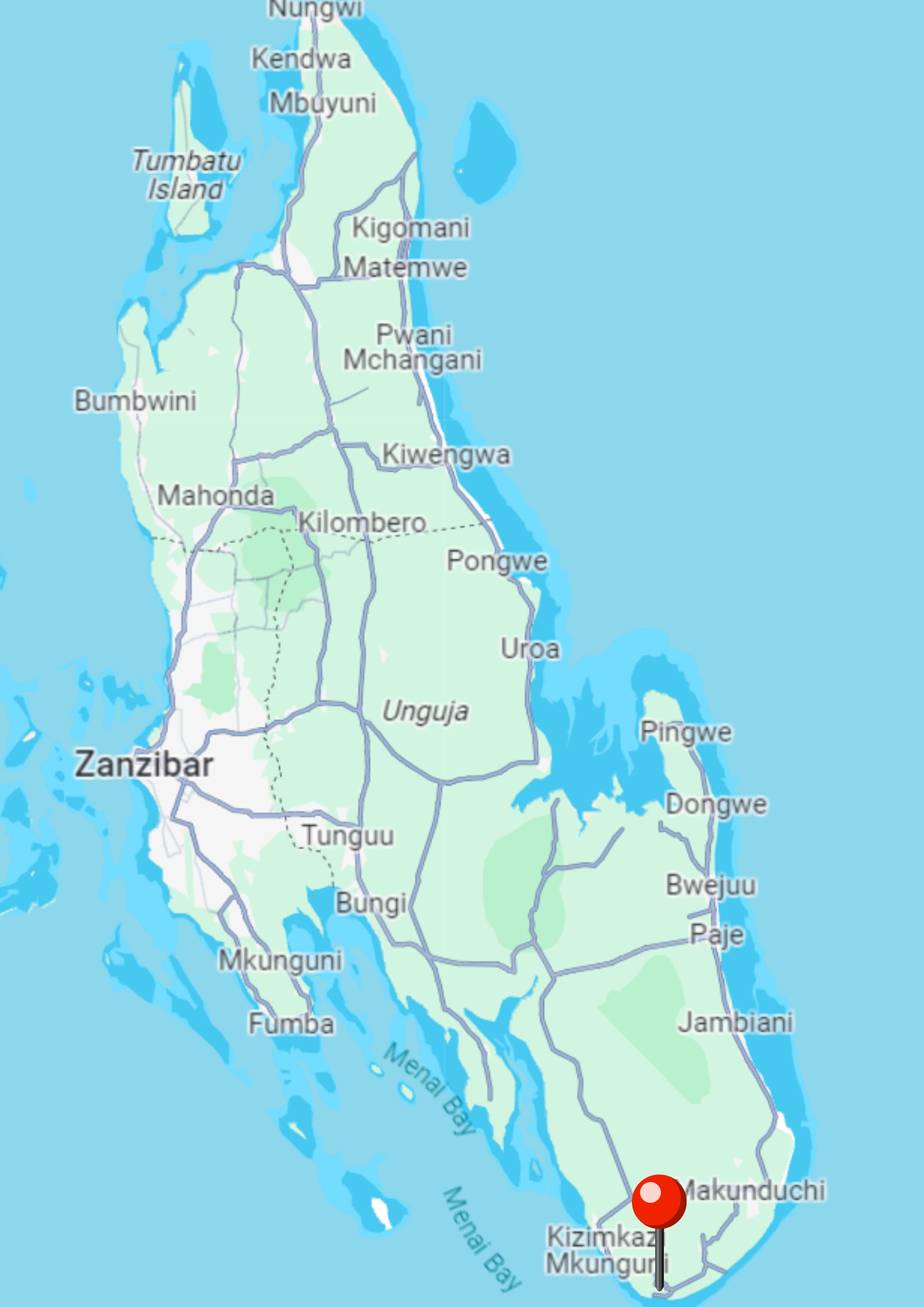

Nungwi

Kendwa

Mbuyuni

Tumbatu Island

Kigomani

Matemwe

Pwani
Mchangani

Bumbwini

Kiwengwa

Mahonda

Kilombero

Pongwe

Uroa

Unguja

Pingwe

Zanzibar

Dongwe

Tunguu

Bwejuu

Bungi

Paje

Mkunguni

Fumba

Jambiani

Menai Bay

Menai Bay

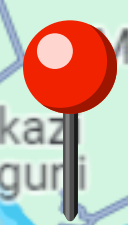

Makunduchi

Kizimkazi
Mkunguni

SITE PLAN OF KIZIMKAZI DIMBANI
SCALE: 1000 - ZANZIBAR



ZANZIBAR LUXURY
PROPERTIES

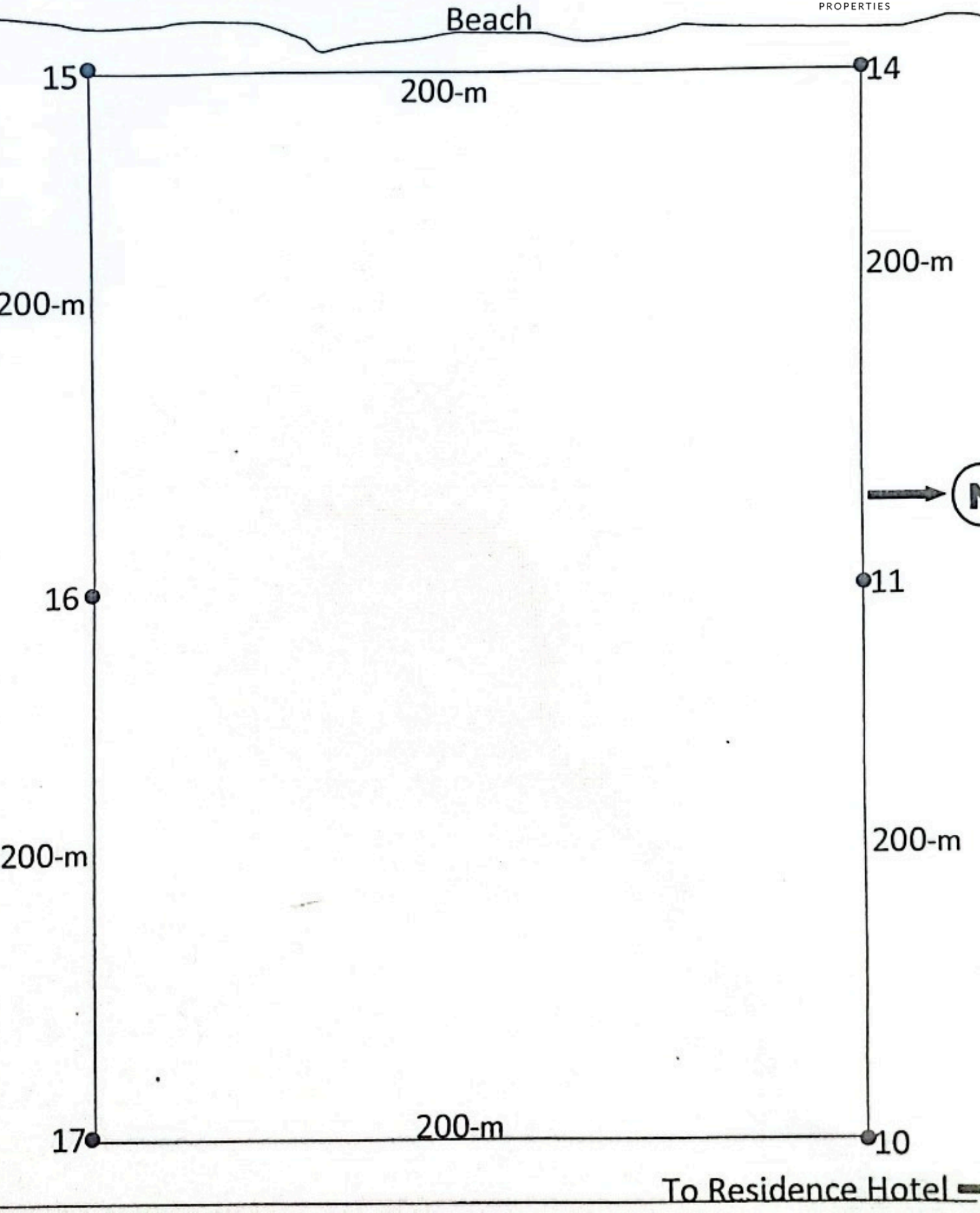







ZANZIBAR LUXURY
PROPERTIES

OUR CONTACTS

www.zanzibarluxproperties.com

info@zanziluxproperties.com

+255 772 415 889



[zanzibarluxuryproperties](https://www.instagram.com/zanzibarluxuryproperties)



[Zanzibar Luxury Properties](https://www.facebook.com/ZanzibarLuxuryProperties)



[Zanzibar Luxury Properties](https://www.linkedin.com/company/ZanzibarLuxuryProperties)

